

PROFILE CLAMPS

Profile Clamps make installing TECOM's material handling system components, quick and easy. No welding required. Simply position, shim if necessary, and fasten securely. Then the Guide Rail Profiles can be inserted into the Profile Clamps and tightened in place. For extra convenience combine TECOM Profile Clamps with bolt on TECOM Flange Weldments.

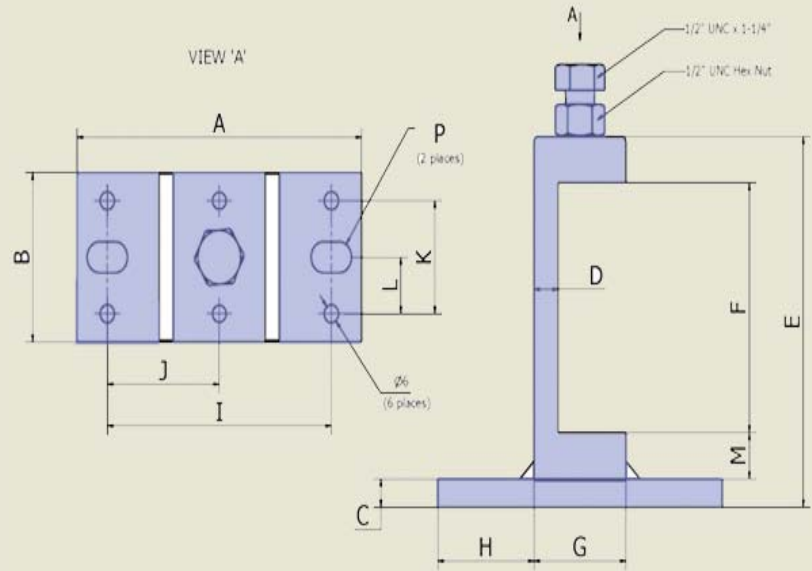

| Part Number | A | B | C | D | E | F | G | H | I | J | K | L | M | P | PROFILE |
|-------------|-----|------|-----|------|-------|-------|------|------|-----|----|-----|-----|-------|-------|---------|
| | mm | mm | mm | mm | mm | mm | mm | mm | mm | mm | mm | mm | mm | mm | |
| CL10 | 100 | 50.8 | 9.5 | 7 | 96 | 67 | 36 | 32 | 70 | 37 | N/A | N/A | 9.75 | 1/2" | 53U |
| CL20 | 127 | 60 | 10 | 10.8 | 131.3 | 88.5 | 41 | 43 | 100 | 50 | 40 | 20 | 16.4 | 11x18 | 2890 |
| CL30 | 127 | 60 | 10 | 12.7 | 145.4 | 105 | 53 | 37 | 100 | 50 | 40 | 20 | 15.2 | 11x18 | 2867 |
| CL40 | 162 | 89 | 15 | 14 | 172.2 | 123 | 61.2 | 50.4 | 130 | 65 | 60 | 30 | 17.1 | 13x18 | 2810 |
| CL50 | 162 | 89 | 15 | 16.2 | 190 | 137.5 | 66.2 | 47.9 | 130 | 65 | 60 | 30 | 18.75 | 13x18 | 2811 |
| CL60 | 162 | 89 | 15 | 19.4 | 216.5 | 159 | 71.2 | 45.4 | 130 | 65 | 60 | 30 | 21.3 | 13x18 | 2862 |

CL10 does not have the 6mm tooling holes at six locations. All other sizes do. CL10 has 5/16" UNC x 1" bolt and nut.



PROFILE CLAMPS

-
1. BOLT
 2. NUT
 3. PROFILE BODY
 4. WELDED MOUNTING PLATE
 5. SLOTTED MOUNTING HOLES
 6. TOOLING HOLES
-



Profile Clamps have the following technical characteristics:

- The base plate is made from cold rolled steel welded to rolled and machined guide rail profile.
- They come furnished with 1/2" UNC x 1=1/4" bolts and 1/2" UNC hex nuts (CL10 comes with 5/16" UNC x 1" bolt and nut).
- With the exception of the CL10 all plates have six 6mm diameter tooling holes
- Each plate has two slotted fastening holes.